

# Trailside Townhomes



COLORED "CONCEPT" ELEVATION

# PROJECTS BY THE ALPERT FAMILY



# PROJECTS BY THE ALPERT FAMILY



# PROJECTS BY THE ALPERT FAMILY



# PROJECTS BY THE ALPERT FAMILY



# PROJECTS BY THE ALPERT FAMILY



# PROJECTS BY THE ALPERT FAMILY



*Willow Point*  
8500 E. MISSISSIPPI AVE.

# PROJECTS BY THE ALPERT FAMILY





# PROJECTS BY THE ALPERT FAMILY



# Trailside Townhomes: CURRENT CONDITIONS



# Trailside Townhomes: CURRENT CONDITIONS



# Trailside Townhomes: CURRENT CONDITIONS



# Trailside TOWNHOMES PROJECT: CURRENT CONDITIONS



# Trailside TOWNHOMES PROJECT: CURRENT CONDITIONS





2550 South  
Syracuse Way





# 1<sup>st</sup> submittal SITE PLAN FOR the Trailside TOWNHOMES

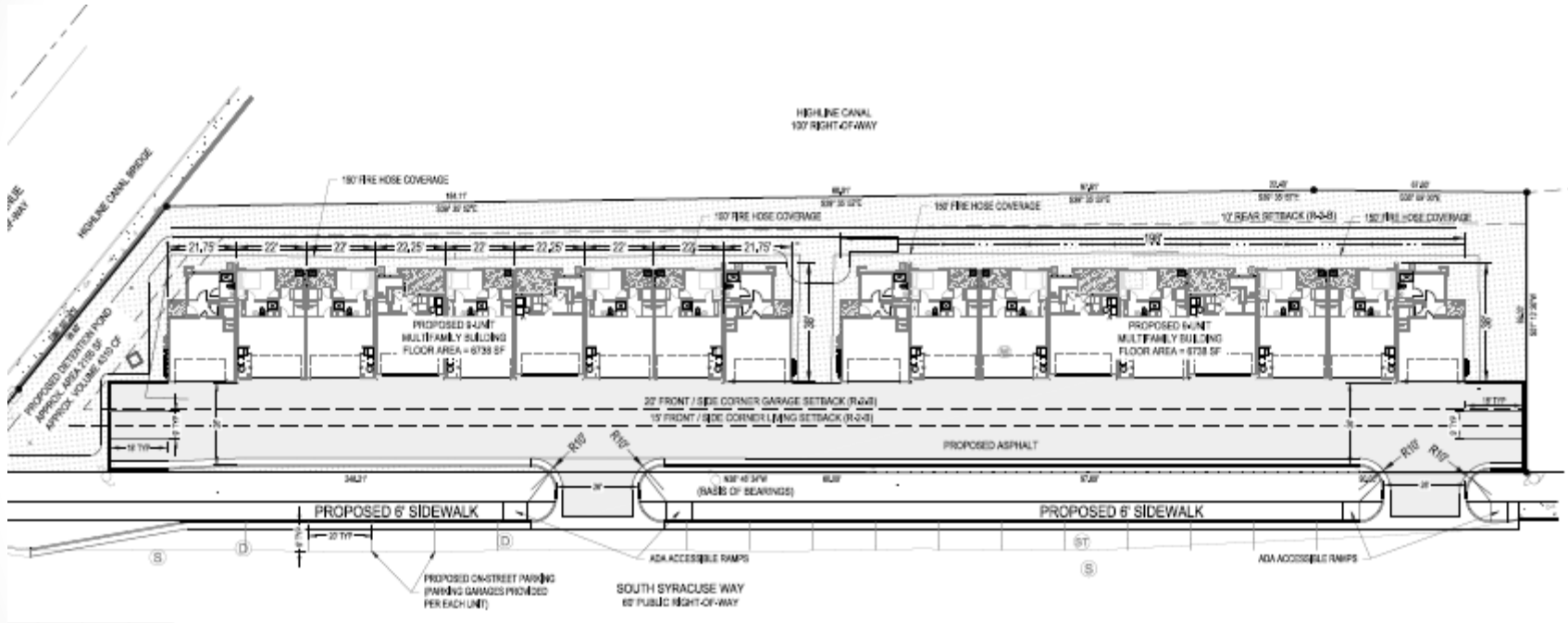

Submitted: 2021

# 7<sup>th</sup> submittal - SITE PLAN FOR the Trailside TOWNHOMES

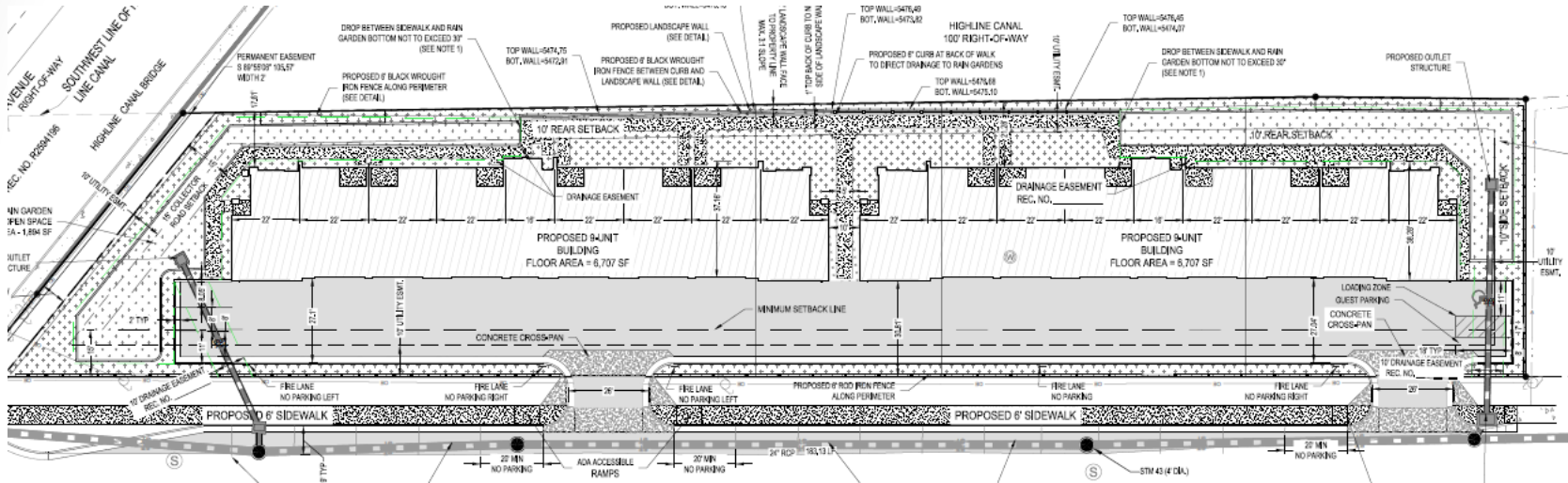

# Landscape PLAN FOR the Trailside TOWNHOMES

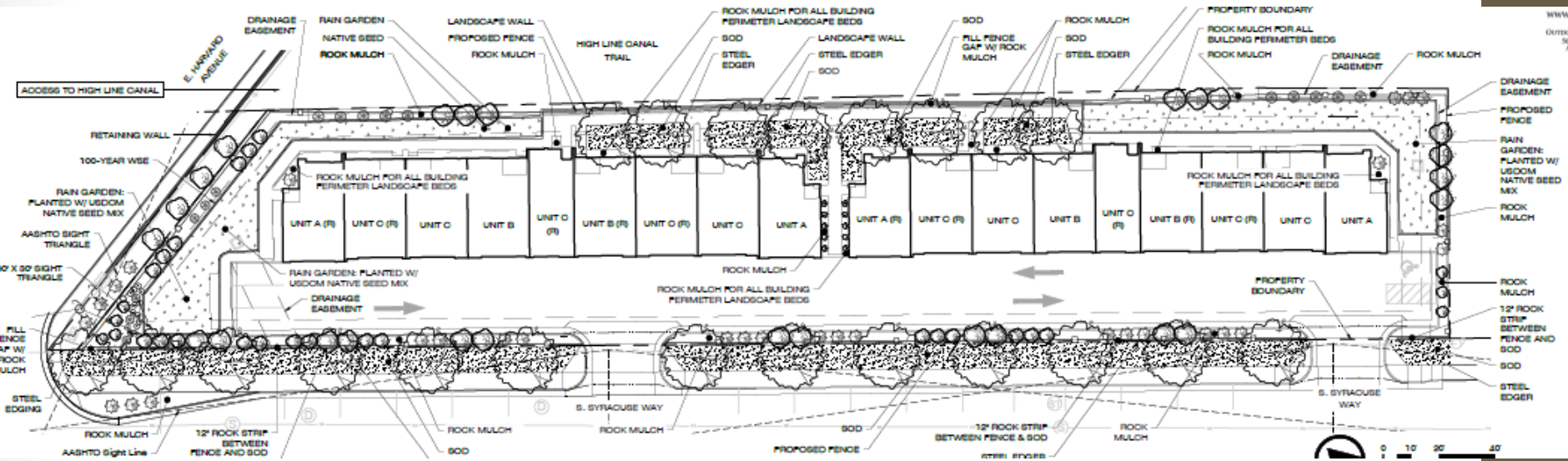

WWW.ODG  
OUTDOOR DESIGN  
500 NORTH  
AVENUE, C  
GREEN

# EXAMPLE OF GREENBELTS



# Similar PROPOSED ELEVATION



COLORED "CONCEPT" ELEVATION

# ELEVATION

