

**RESOLUTION NO. 25-**\_\_\_\_\_ It was moved by Commissioner \_\_\_\_\_ and duly seconded by Commissioner \_\_\_\_\_ to approve and accept the conveyances from Montessori School of Washington Park to Arapahoe County of right of way interests in Parcel ROW-2, upon the recommendation of the County's Project Engineer and the Director of Public Works and Development Department, with said right of way interests being granted in the following real property:

**EXHIBIT 'A'**  
Legal Description

**Parcel: ROW-2**

A parcel of land, ROW-2, lying within property described and recorded at Reception Number E3000989 on January 4<sup>th</sup>, 2023, in the Arapahoe County Clerk and Recorder's Office and being in the Southwest One-Quarter of Section 29, Township 4 South, Range 67 West of the 6th Principal Meridian, County of Arapahoe, State of Colorado, being more particularly described as follows:

Commencing at the Southwest Corner of said Section 29;

Thence N84°02'04"E, a distance of 440.63 feet, to a point on the East Right of Way line of South Holly Street, being the Point of Beginning;

1. Thence departing said East line N20°13'41"E, a distance of 3.55 feet;
2. Thence S69°46'19"E, a distance of 7.00 feet;
3. Thence S20°13'41"W, a distance of 4.00 feet;
4. Thence S69°46'19"E, a distance of 7.90 feet;
5. Thence N70°13'56"E, a distance of 7.90 feet;
6. Thence S67°53'16"E, a distance of 13.38 feet;
7. Thence N89°55'51"E, a distance of 148.44 feet;
8. Thence N43°31'20"E, a distance of 10.67 feet to a point on the West Right of Way line of South Jersey Street;
9. Thence following said West line along a curve to the right with a radius of 20.00 feet, a delta angle of 34°51'51", an arc length of 12.17 feet, and whose long chord bears S31°06'42"W for 11.98 feet to a point on the North Right of Way line of East Yale Avenue;
10. Thence along said North line S89°57'12"W, a distance of 166.37 feet to a point of curvature on said East line;
11. Thence departing said North line and following said East line along a curve to the right with a radius of 63.86 feet, a delta angle of 17°51'58", an arc length of 19.91 feet, and whose long chord bears N58°17'24"W for 19.83 feet to the Point of Beginning;

Containing an area of 553 square feet or approximately 0.013 acres, more or less.

Basis of Bearings: Bearings herein are based on the Section line common to the Southwest Quarter of Section 29 and the Northwest Quarter of Section 32, Township 4 South, Range 67 West, of the 6TH P.M., having a Colorado Central Zone NAD 83 (2011) grid bearing of N89°57'12"E, said line being monumented on the west by the Northwest Corner of said Section

32 (a 3.25 inch aluminum cap in a Range Box, PLS 23521), and on the east by the North One-Quarter Corner of said Section 32 (a 3.25 inch aluminum cap in a Range Box, PLS 23521).

Ramon L Sanchez, PLS 38605  
For and on behalf of David Evans and Associates,  
1600 Broadway Ste 800  
Denver, CO 80202

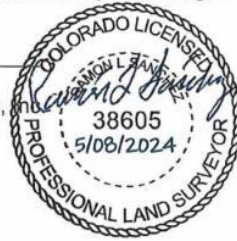

The vote was:

Commissioner Baker,\_\_\_; Commissioner Campbell,\_\_\_; Commissioner Fields,\_\_\_; Commissioner Summey,\_\_\_; Commissioner Warren-Gully,\_\_\_.

The Chair declared the motion carried and so ordered.