

EXHIBIT A

Legal Description

A Parcel of Land situated in the Southeast Quarter of the Southeast Quarter of Section 6, Township 5 South, Range 65 West of the 6th Principal Meridian, County of Arapahoe, State of Colorado, more particularly described as follows:

Commencing at the southeast corner of said Section 6 and considering the south line of said Southeast Quarter of the Southeast Quarter of Section 6 to bear North 89°57'17" West relative to the Colorado Coordinate System of 1983, Central Zone;

Thence North 00°28'35" East along the east line of said Southeast Quarter of Section 6, a distance of 55.00 feet to a point on the northerly line of that certain property conveyed to Arapahoe County in QuitClaim Deed recorded August 8, 1978 in Book 2826 at Page 723, the Point of Beginning;

Thence North 89°57'17" West along said northerly line and along the northerly line of East Quincy Avenue, a distance of 1073.77 feet;

Thence North 86°23'06" East, a distance of 557.25 feet;

Thence South 89°58'35" East, a distance of 224.77 feet;

Thence South 83°35'45" East, a distance of 294.73 feet to a point on said east line of the Southeast Quarter of Section 6;

Thence South 00°28'35" West along said east line, a distance of 3.02 feet to the Point of Beginning,

containing 23,561 Square Feet, or 0.541 Acres, more or less.

All lineal distances are represented in U.S. survey feet.

Prepared February 17, 2023 by L.J. Ludeman
1309 S. Inca Street, Denver, CO 80223

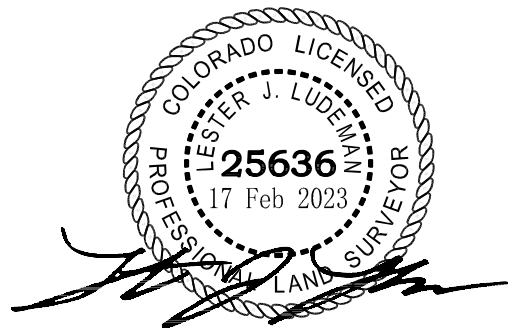

ILLUSTRATION FOR EXHIBIT A

City & County
of Denver

Point of Beginning
Found No. 5 Rebar & 1.25" Yellow Plastic
Cap stamped ENGR. SER. CO. LS 27609

Arapahoe County Fairgrounds and Regional Park

N00°28'35"E 55.00'

S00°28'35"W 3.02'

S00°28'35"W 2655.32'

East Line, Southeast Quarter Section 6

Point of Commencement
Southeast Corner Section 6
Found 2.5" Aluminum Cap in
Concrete in Monument Box
stamped PLS 28285 2017

East Quarter Corner Section 6
Found 2.5" Brass Cap on 2.5" Pipe
in Concrete stamped LS 9652 1988

Lowry Environmental Protection/
Cleanup Trust Fund

East Half, East Half, Section 6
Township 5 South, Range 65 West

Lowry Environmental Protection/
Cleanup Trust Fund

Reception No. A9189220 (1999)
Reception No. A9189221 (1999)
Reception No. A9189222 (1999)
Reception No. A9189227 (1999)

South Harvest Road

Parcel A, Rec. No. B2033414
City of Aurora Fee Parcel, Rec. No. B2222253

OWNER:
Waste Management of Colorado, Inc.
5500 S. Quebec St. Suite 250
Greenwood Village, CO 80111

Lowry Environmental Protection/
Cleanup Trust Fund
Book 7310 Page 619



S83°35'45"E
294.73'

S89°58'35"E
224.77'

N86°23'06"E 557.25'

N89°57'17"W 1073.77'

East Quincy Avenue

Bearing Basis, South Line, SE 1/4 SE 1/4 Section 6

N89°57'17"W 1318.58'

114'

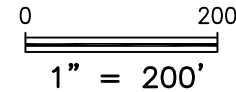

● = Set No. 5 Rebar & 1.25" Orange Plastic Cap stamped PLS 25636 unless noted otherwise

County of Arapahoe Fee Parcel
Book 2826 Page 723 (1978)
(Being used as Public Right of Way)

55'

40'

East Sixteenth Corner Sections 6 and 7
Found 2.5" Brass Cap in Monument Box
stamped LS 9652 1988

THE ABOVE DESCRIBED PARCEL CONTAINS 23,561 SQUARE FEET OR (0.541 ACRES) MORE OR LESS.
This illustration does not represent a monumented survey. It is intended only to depict the attached legal description.

ARAPAHOE COUNTY, COLORADO

A PARCEL OF LAND SITUATED IN THE SE 1/4
OF THE SE 1/4, SECTION 6, T. 5 S., R. 65 W.
OF THE 6TH P.M. ARAPAHOE COUNTY, COLORADO

DRAWN BY:
LJL

SCALE:
1"=200'

R.O.W. FILE NUMBER

CHECKED BY:

DATE:
2/17/23

JOB NUMBER: